



200mW DAP202U SWITCHING DIODE

DAP202U SWITCHING DIODE

FEATURES:

Power dissipation

$$P_D: 200 \text{ mW (} T_{amb}=25^\circ\text{C)}$$

Collector current

$$I_F: 100 \text{ mA}$$

Collector-base voltage

$$V_R: 80 \text{ V}$$

Operating and storage junction temperature range

$$T_J, T_{stg}: -55^\circ\text{C to } +150^\circ\text{C}$$

SOT-323

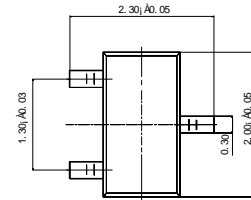
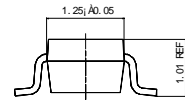
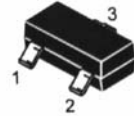

Unit mm

CIRCUIT:

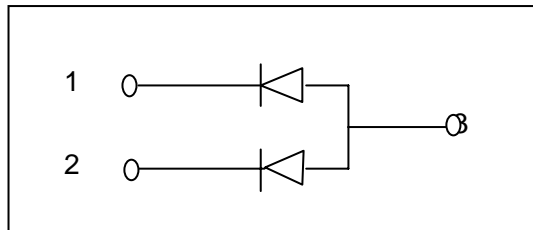

MARKING: P

ELECTRICAL CHARACTERISTICS ($T_{amb}=25^\circ\text{C}$ unless otherwise specified)

| Parameter | Symbol | Test conditions | MIN | MAX | UNIT |
|---------------------------------|------------|---------------------------------|-----|-----|---------------|
| Reverse breakdown voltage | $V_{(BR)}$ | $I_R=100\mu\text{A}$ | 80 | | V |
| Reverse voltage leakage current | I_R | $V_R=70\text{V}$ | | 0.1 | μA |
| Forward voltage | V_F | $I_F=100\text{mA}$ | | 1.2 | V |
| Diode capacitance | C_D | $V_R=6\text{V}, f=1\text{MHz}$ | | 3.5 | pF |
| Reverse recovery time | t_{rr} | $V_R=6\text{V}, I_F=5\text{mA}$ | | 4 | ns |