

**PIFR3501~3506 N/ P**

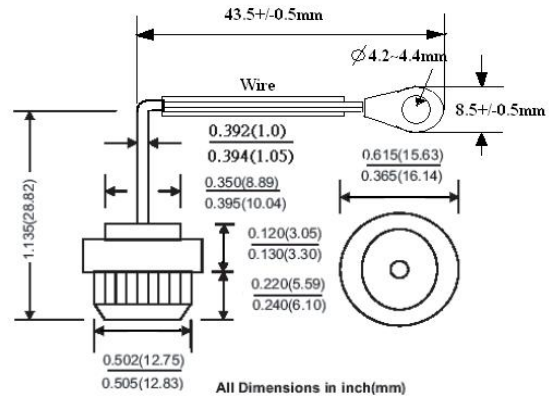

INSULATE PRESS-FIT



**Features**

- Low Cost
- Super Cool
- Long life Features
- High Current Capability

**NOTE:**

- **1. PILFR35XXP Positive (Forward) (+)**  
Cathode To Case, Color Code Red
- **2. PILFR35XXN Negative (Reverse) (-)**  
Anode To Case, Color Code Black
- 3. Lead have 1mm, 1.3mm And 2.5mm

Electrical Characteristics@25C	Symbol	PIFR3501P PIFR3501N	PIFR3502P PIFR3502N	PIFR3504P PIFR3504N	PIFR3506P PIFR3506N	Unit
Average Forward Current, I <sub>o</sub> at T <sub>c</sub> =150C 60HZ, Resistive Or Inductive Load	IF	35				A(DC)
Peak Reverse Voltage, Repetitive:VRRM	VRRM	100	200	400	600	V(DC)
DC Reverse Voltage, VR	V(DC)	100	200	400	600	
Maximum RMS Voltage	VRMS	70	140	280	420	
Max. Inst Forward Voltage Drop. VF at 100Amp	VF	1.2				V
Peak Forward Surge Current, IFM(surge): 8.3ms. Single Half Sine-Wave Superimposed On Rated Load (JEDEC method)	IFSM	400				A
Maximum Reverse Current IR At Rated DC Reverse Voltage. TC= 25C	IR	10				uA
Maximum Reverse Current IR At Rated DC Reverse Voltage. TC=100C	IR	500				uA
Maximum Thermal Resistance, Junction To Case (single side cooled)	R <sub>θJA</sub>	0.8				C/W
Operating And Storage Temperature Range	T <sub>j</sub> ; T <sub>strg</sub>	-65 to +175				C