

PBFR5001~5006 N/ P

DESCRIPTION



BOSCH TYPE PRESS-FIT

MECHANICAL DIMENSIONS

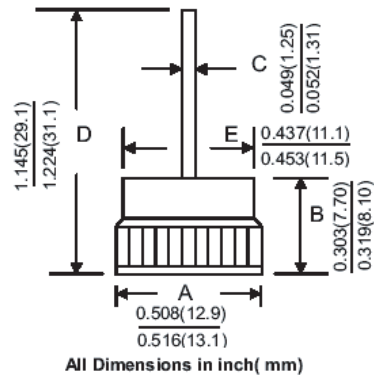

Features

- Low Cost
- Super Cool
- Long life Features
- High Current Capability

NOTE:

- 1.PBFR500XP Positive(Forward),(+) Cathode To Case, Color Code Red
- 2.PBFR500XN Negative(Reverse),(-) Anode To Case,Color Code Black

Electrical Characteristics@25C	Symbol	PBFR5001P PBFR5001N	PBFR5002P PBFR5002N	PBFR5004P PBFR5004N	PBFR5006P PBFR5006N	Unit
Average Forward Current, I _o at T _c =150C 60HZ, Resistive Or Inductive Load	I _F	50				A(DC)
Peak Reverse Voltage, Repetitive:VRRM	VRRM	100	200	400	600	V(DC)
DC Reverse Voltage, VR	V(DC)	100	200	400	600	
Maximum RMS Voltage	VRMS	70	140	280	420	
Max. Inst Forward Voltage Drop. VF at 80Amp	VF	1.18				V
Peak Forward Surge Current, IFM(surge): 8.3ms. Single Half Sine-Wave Superimposed On Rated Load (JEDEC method)	IFSM	500				A
Maximum Reverse Current IR At Rated DC Reverse Voltage. TC= 25C	IR	10				uA
Maximum Reverse Current IR At Rated DC Reverse Voltage. TC=100C	IR	500				uA
Maximum Thermal Resistance, Junction To Case (single side cooled)	R _{θJA}	0.8				C/W
Operating And Storage Temperature Range	T _j ; T _{strg}	-65 to +175				C